

Think electric.



TECHNOLOGY OF THE FUTURE, TODAY.



mini Z400



ELISE 900^{MK3}

DREAMS COME TRUE

„This is my childhood dream come true! Electric and truly useful, powerful machines that actually move and work by themselves. They are agile and capable, they help people and at the same time they don't harm the environment at all.“

No virtual world, no Lego toys, no little models I used to play with as a kid. But real machines, our skid steer loaders. And you know what the best part is? They're made in our new factory in the Czech Republic, just outside of Kladno.

Made by our own team of people who enjoy working in our company, feel comfortable working with us and are also incredibly skilled, honest and hardworking. Some of them have been by our side since the beginning, since moving from a neighbouring country. We managed to move and grow in record time, with uncertainty, respect but also anxiety. It's not always easy, but we enjoy it. We want to work honestly and fight for our place in the sun, in a fierce competition from all over the world. But we believe. We believe in ourselves, in our work, in our development, in our abilities and we believe in our machines.

We have combined the best of the Czech and Slovak teams and we have electric machines that we are proud of - Elise 900 and MiniZ 400. And I personally hope that it doesn't end just with them...

This is the realization of my childhood dream and proof that dreams and not only children's dreams really do come true!

MARTIN HAVRDA
CHAIRMAN OF THE BOARD
FIRSTGREEN Industries



Arbol is a tree that grows and branches gradually. Its strength comes from its roots, which must be strong, deep and stable. And on such a foundation lies the common dream of doing business properly, responsibly and with a vision of the future.



First Green Industries, a. s.

Innovative production of 100% environmentally friendly loaders with a global reach.



Labit a. s.

Development company focusing on ecological projects in the Vrchlabí area. Our goal is to actively help improve the environment and bring new life to Vrchlabí.



Arbol Rokytnice, s. r. o.

Phased development of exclusive and original mountain apartments in one of the best mountain resorts in Rokytnice nad Jizerou in the heart of the Krkonoše Mountains.



Apartmány Konírna

Development of luxury mountain apartments within the Dřevona recreational area.



Apartmány Dřevona

Complete reconstruction of a sports and recreation complex in the Jizera Mountains.



Planet A, a. s.

Building a telecommunications company with subsequent sale to a strategic partner.



Česká lékárna, a. s.

Establishment of a chain of pharmacies with subsequent sale to a domestic financial group.

HISTORY

INTRODUCTION OF ARBOL CAPITAL

The production of the Elise 900 and MiniZ 400 is now carried out under a separate business entity and both machines are entering the global market. The project has started in Slovakia and surrounding countries and is rapidly expanding to other countries not only in Europe but also overseas. The new sales team has big ambitions and is preparing to build an international partner network.

2021

MOVING TO CZECH REPUBLIC

Arbol Capital, together with key managers and engineers, controls 100% of the company's shares. Along with the change of ownership, production is being moved to a brand-new production facility in Velká Dobrá. In September 2021 the first machine is produced in the new factory and in October we officially introduce the factory to our partners and customers. We can now produce up to 700 machines per year. We end the year in 37 countries with more than 60 partners.

2022

NEW GENERATION OF *ELISE 900*

The best example how much we value the opinion and shared experience with our customers is the new generation of our Flagship product Elise 900. This 3rd generation machine has almost 40 improvements providing amazingly higher quality and better operational experience.

OPENING OF NEW BRANCH IN US

To provide our overseas customers and partner network with timely delivery and best customer service, we decided to open our first international subsidiary in Asheville, North Carolina. With significant stock of both Elise and MiniZ, combined with flexible and sufficient spare parts and logistics, we are able to serve the market with the highest possible quality.

NEW TRAINING CENTRE IN CZECH REPUBLIC

Continuous improvement of our partnership network requires also regular technical, marketing and sales training. In order to provide that we opened a new training center in Prague for our European partners who are always welcome to come to visit our factory. Transparency to our partners is one of our key company values.

2023

NEW GENERATION OF *miniZ400*

Our R&D team has currently finished the implementation of improvements to our MiniZ 400 compact loader and its production started in March 2023.

THE FUTURE IS ELECTRIC

Our plans are once again a bit more ambitious. We are expanding the team, focusing on new markets and the R&D team is working with suppliers to develop a new generation of Elise 900, MiniZ 400 and electric attachments. And for our dealers, there is now a service and sales support department. And so far, we are still the only ones on the market..

500+
Machines produced

100+
Dealers

3
Generations of machines

75+
Staff

2500 m³
Of production capacity

2024

2025

When we know what we want to achieve, anything is possible. We have a single-layer and flexible company structure. We're not a start-up or a corporation. We combine the best of both worlds.

„Every unsolvable problem has a simple solution. You just have to find it in a reasonable amount of time.“

SLAVO PETRENEC
CHIEF DEVELOPER



FLEXIBILITY

FLEXIBILITA

Company structure

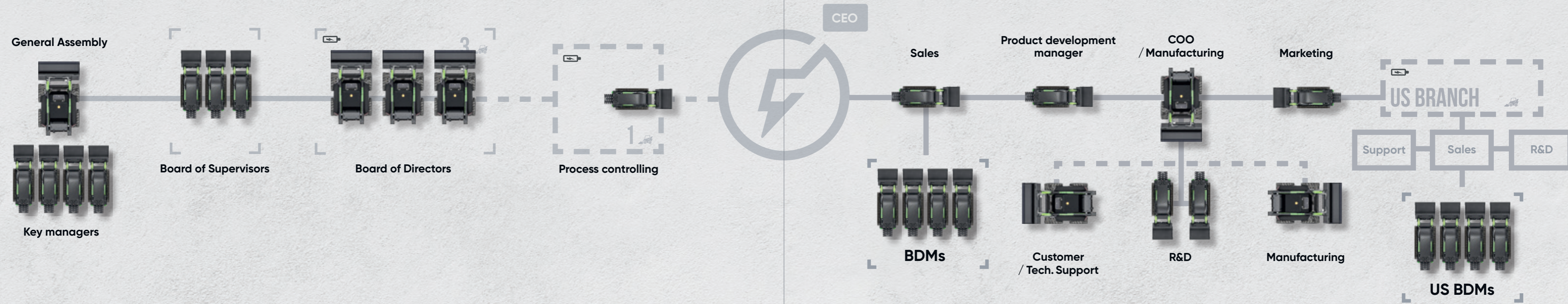

We always lay our cards on the table and play fair. And it doesn't matter whether it's our employees, partners, suppliers or customers.

„Respect fair-play, tell the truth. That's fundamental. Whether in sport or at work, in life. It is not just about being able to win, but to lose with your head held high, humility and respect for your opponent. To learn from your losses and move on.“

MARTIN HAVRDA
CHAIRMAN OF THE BOARD



HONESTY

UPŘÍMNOST

Martin Havrda

CHAIRMAN OF THE BOARD

Sport has been with me all my life. Apart from swimming, tennis and skiing, it was mainly modern pentathlon, five discordant, even aristocratic disciplines combined into one. Perhaps this is the source of my desire to try new fields, to develop companies, but also my diligence and ability not to be afraid of failure.

I am an economics graduate, I spent the final part of my studies in the USA, where I also had the opportunity to run a business. Two key people have shaped my view of the world and how to behave in life and in business. My long-time modern pentathlon coach, with whom much of my youth was spent, and then my dad, with whom I started and ran several successful businesses together. First it was the pharmacy business where I gained experience alongside him. Subsequently, my team and I spent 12 years building and running a telecoms company that became an exciting target for a multinational telecommunications operator.

„Providing financial stability, strategic management and directing everything to work perfectly, grow healthily and prosper.“



Vítězslav Vojáček

CEO

I have known Martin Havrda and his father for many years, and during that time we have developed a successful cooperation and relationship. I have worked in small, medium and large companies. Start-ups and corporations. And I'm very clear. Start-ups or companies in the early stages of development are many times more attractive to me. They force you to think about how to move the company forward, they force you to make decisions, then change them and maybe even correct the mistakes that have been made. It forces you to study the experiences of others, to repeatedly return to the same situations and revise them.

All this is tiring, but also exciting. But the main bonus of this situation is that one can influence things and the final effect is a product on which one's signature is visible. It's a bit like bringing up a child.

„My job at FIRSTGREEN Industries is the general responsibility for fulfilling the shareholders' assignments. I personally have the ambition to exceed them, because our product deserves it.“

Lukáš Rameš

MEMBER OF THE BOARD, COO

I graduated from CTU and then spent some time teaching future generations in IT. However, quite soon I moved into the real world of IT. I joined Martin and Hanka's team in 2012 at Planet A. At the end of 2020, I took over the position of Chief Operating Officer also at FIRSTGREEN Industries.

I enjoy seemingly ordinary things. Working in the garden, working on the house I built almost entirely with my own hands, trips with my daughters. Or maybe a „cold one“ with friends at a raft in Central Bohemia, where I have lived all my life.

This practical life attitude allows me to accomplish things that sometimes seem like „mission impossible“.

„I enjoy being with my colleagues directly in on the production floor, helping them solve specific tasks during assembly, putting my hands to work. And I also enjoy coming up with all sorts of improvements that could take the machines up another notch.“



Hana Holubová

MEMBER OF THE BOARD

I spent the first part of my professional life in the healthcare sector, but after my maternity leave, I took part in developing the family telecommunications company Planet A together with Martin. After its sale, I continued with Martin to the investment group Arbol Capital, where I am in charge of the operational running of the whole group and all its portfolio companies.

At FIRSTGREEN, as a member of the Board of Directors, I mainly take care of procedural matters, contractual relations and personnel policy.

„I believe that the people I work with across all of our companies share a desire to do original and unusual things. The machines manufactured at FIRSTGREEN are perfect for this purpose.“

We are not just a company that is economically successful. We are people and we care about others. We care about our employees, our co-workers. We care about our partners, our customers. We care about the country in which we do business. We pay our obligations and we don't look for loopholes. We care about our environment, nature, our children and the world around us. We are a responsible company with everything that goes with it.

„We can do even the simplest, most insignificant thing in the world, but we do it to the best of our ability.“

TOMÁŠ BAŤA

CZECH "KING SHOEMAKER"
AND FOUNDER OF THE BAŤA EMPIRE



RESPONSIBILITY

ZODPOVĚDNOST

Václav Audes

CHAIRMAN OF THE SUPERVISORY BOARD
LEGAL AFFAIRS

Before I graduated from Prague Law School, I spent half of my life abroad - in India, Germany, France and Spain.

Today, I am a partner at Havel Partners, a law firm that for many years has provided legal services to the Havrda family in all areas of their business and private activities. This cooperation has gradually grown into a business and personal friendship. The broader spectrum of family investments and the need for professional management resulted in the establishment of Arbol Capital. Here, I am involved in the investment strategy and I'm responsible for the investment pipeline, trading and legal compliance areas.

„The countries I have lived in have enriched me with one insight: no matter whether a country is poorer or richer than the Czech Republic, there are always people who are a fountain of wisdom, have great goals and are an inspiration for a truly fulfilling life.“



Veronika Filipová

CONTROLLING

I started my legal career in 2005 by studying at the Police Academy in Prague in the Master's degree in Law and Security Service. I continued my studies at the Law Faculty of Charles University in Prague. I primarily focus on corporate and commercial law.

I met Martin, Lukáš and Hana for the first time professionally during the acquisition process of their previous telecommunications company, through which I guided them (on behalf of the selling party) together with Václav. Immediately afterwards we started working together within the Arbol Capital group.

In FIRSTGREEN I am responsible for all contractual relations, all legal ties and process controlling. I am also a member of the supervisory board.

„I love my family, my little daughter, travelling, sports and walking. When I am in nature, I feel immense satisfaction that I am actively contributing to its conservation through my work. From my position as an attorney, this seems seemingly unrelated and not directly influential, but my colleagues and I know that this is our common interest and we each contribute our part.“

We want to materialize our dreams and create machines that are unique, timeless and perhaps change the way we see the world. We want to do things that are meaningful, not only for ourselves, but for future generations.

„I believe in our products and in our entire manufacturing and development team. We can do great things together.“

LUKÁŠ RAMEŠ
COO & MEMBER OF THE BOARD



Undisturbed serenity, only with electric
Elise 900 on duty near Basilica di San Paolo in Rome

DESIRE TOUHA

Research and development

We believe in continuous improvement of the capabilities of our machines, thus adding value to their existing and new owners. We work on expanding battery capacities for longer life and efficiency, updating control firmware and new capabilities in the form of eAttachments.



2022

ELISE 900 MK3

The new generation Elise 900 introduces a range of enhancements to optimize operations, improve reliability and machine controllability from the perspective of operator experience. Increased quality of metal parts, including new surface coating technologies, new motors for drive and hydraulics, hard-mount display and technological preparation for future installation of additional components and upgrades takes the capability of the Elise to the next level.



2023

LITHIUM-ION BATTERY

For 2023, we have set ourselves the goal of providing our customers with an advanced lithium battery for both the Elise 900 and MiniZ 400. The aim of the development was zero maintenance and a higher number of charging cycles. This new version is now available as packet option for both machines.

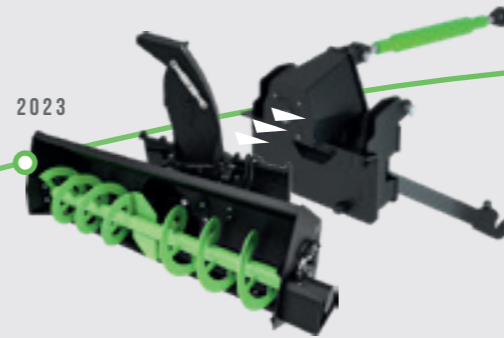

2023

eATTACHMENTS

To take the efficiency of our machines to the next level, we are developing electrically driven attachments, or eAttachments. These save more energy, are more efficient and easier to maintain thanks to their drive compared to conventional hydraulic motor-driven rotary peripherals.



2023

ELISE 700

A lightweight version of the Elise, with a lithium battery and smaller wheels. Built for easy transport - weighing just 2,700 kilograms, a full 600 kg lighter than Elise 900, it can be transported behind a regular car on a trailer. It is therefore ideal for rental companies and contractors. Its lighter weight also makes it more agile, with lower energy consumption.



2023

MINI Z 400 MK2

The upcoming next generation of MiniZ 400 MK2 will improve the machine in several ways. The upgraded, robust design will maintain the compact size of the machine, but add protection for critical components and improve overall stability. The machine will also have a higher level of waterproofing, up to IP67, which will be a great advantage in agriculture. The new control panel will make the MiniZ 400 MK2 more user-friendly than ever.

We were told that the electrification of heavy machinery was nonsense. We've proved it's not. It took a lot of courage. Courage to stand out from the crowd.

„Today, we are not afraid to take our electrified machines others don't want to go. Into the mountains, freezing temperatures and other extreme conditions, where our machines work flawlessly. Our courage has paid off.“

VÍTEZSLAV VOJÁČEK
CEO



Unstoppable performance, in any weather
Elise 900 on Mölltal Glacier

COURAGE

ODVAHA

We think globally.

FGI North Carolina

FGI Czech Republic



Dealer network in 2020

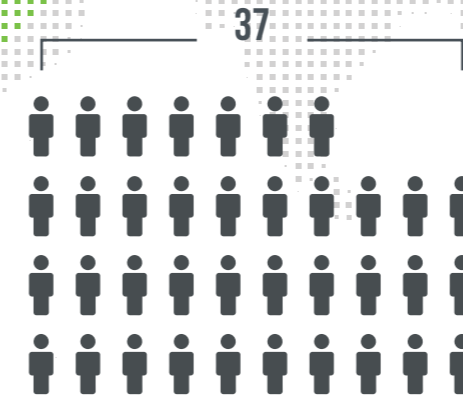

Dealer network in 2021

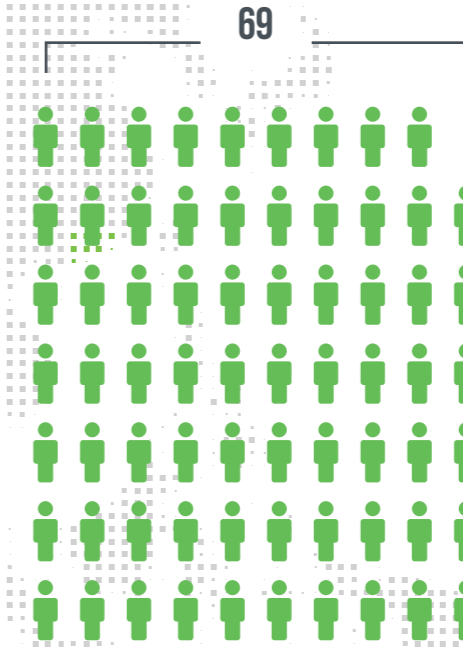

Dealer network in 2022

Dealer network in 2023

90+ Dealers

FIRSTGREEN KEEPS GROWING

We are growing further, expanding our existing dealer network as well as our in-house sales team, service and sales support. Our R&D team is working on the next generation of MiniZ 400, efficient electrical attachments and other improvements that will take FIRSTGREEN to the next level. We are expanding into new continents, opening up markets in Asia and the Middle East. Our machines are still the only widely available electric skid steers, and we are years ahead of our competition. Together with our existing and new dealers, we are getting our machines into the construction, demolition and agricultural sectors, but also into ports and surface mines. We think electric, and are showing the whole world how to do it.

Life taught us, that without work, nothing can be achieved. You cannot advance and grow. We are not afraid of working hard, because we know that's what creates success. Development, innovation, production, sales and marketing. We're moving all of this forward by leaps and bounds.

„I work a lot and hard. But I believe I'm being rational, healthy and efficient. Work is my driving force, motivation and fun. I would like my family to share the same life and continue my projects.“

MARTIN HAVRDA
CHAIRMAN OF THE BOARD



Clean and silent, made for protected areas
Elise 900 working on the olive groves of Sardinia

HARD WORK

PRACOVITOST

Current status & growth

Manufacturing the machine

3 days

complete assembly

Production hall

1500 m²

of assembly and storage areas
(with potential for extension)

Production lines

5

Elise 900
stations

3

MiniZ 400
stations

one team per station

Total capacity

750

units

per year*

Number of staff

30+

in assembly and logistics

Structure

50/50

Elise 900 and MiniZ 400

*with the option to increase capacity

WORKING ENVIRONMENT

PRACOVNÍ PROSTŘEDÍ

The FIRSTGREEN Industries production hub, located in Velká Dobrá near Prague, is innovatively designed to prioritise efficiency, employee comfort and safety, and environmental sustainability.

Our facilities are equipped with state-of-the-art production lines and warehouses, complemented by a technologically advanced training centre, a progressive R&D department and logistics offices. Using our versatile polygon, we can fully test and refine our machinery and push our products to new heights of quality and functionality.



Sustainable company

We are proponents of a sustainable society and rely on the ESG criteria methodology.

We focus on innovation in our technology, strict adherence to internal procedures, ethical behaviour with our partners and employees, as well as environmental sustainability.

Environment

- › Recyclable products
- › Emission-free operation
- › Use of alternative energy sources
- › Electricity in production
- › Bio heating of production halls
- › Consistent recycling of waste
- › Environmentally friendly means of transport

Social

- › Focus on consumer protection
- › Diversity of employees in all organisational units of the company
- › Respect for human rights, dignity and quality of working life
- › Company Code of Conduct

Governance

- › Functional organizational structure
- › Employee participation in the ownership structure
- › Clear definition of responsibilities and authority
- › Process control mechanisms
- › Transactional relationships with employees, including remuneration system



Diesel machines

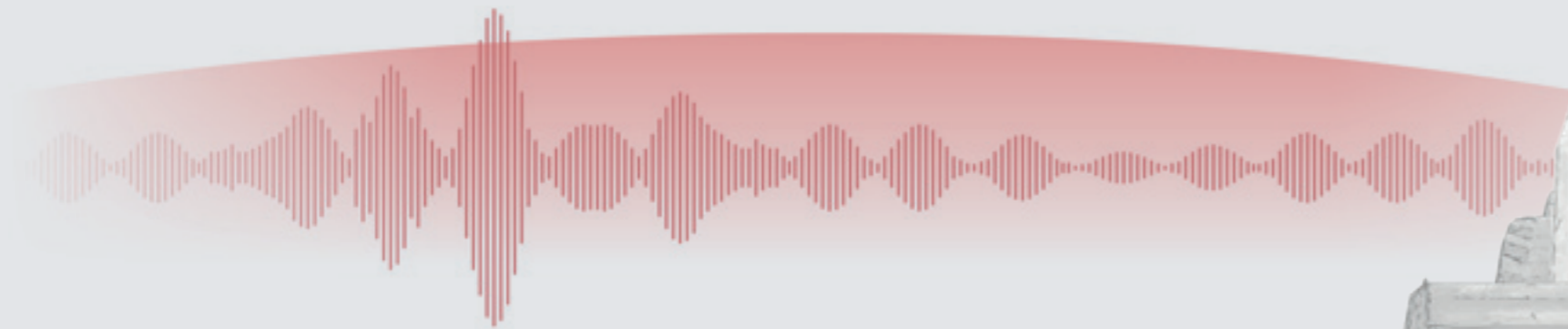

HIGH NOISE LEVEL

HIGH EMISSIONS

AD BLUE CONSUMPTION

NEED FOR REGULAR MAINTENANCE

Chasis height

19_{cm}

Hinge pin height

3_m

Side tilt

36.5°

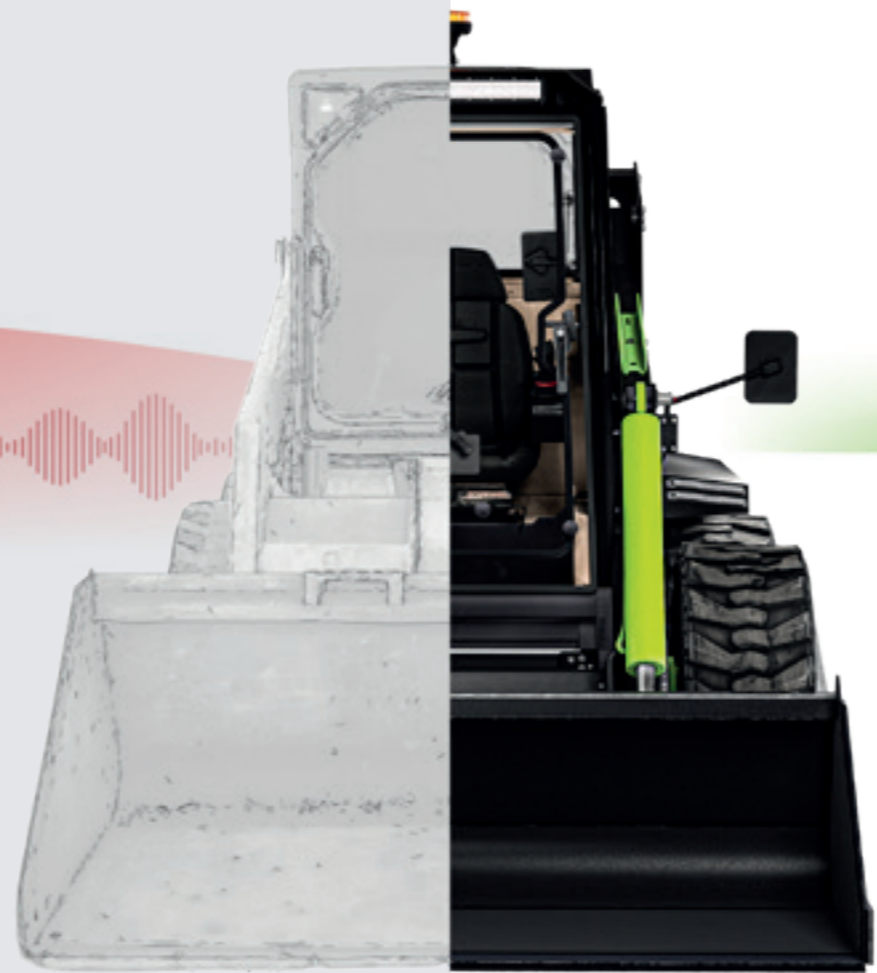

ELISE 900^{MK3}



SILENT OPERATION

ZERO EMISSIONS

MINIMUM OPERATING FLUIDS

MINIMUM MAINTENANCE

Chasis height

26_{cm}

Hinge pin height

3.6_m

Side tilt

47°

Everything we do should contribute to the sustainability of our health, the environment and the resources entrusted to us.

„Arbol means tree, and like our business, it grows and strengthens gradually but steadily. It is built on a solid foundation and deep roots.“

VÁCLAV AUDES

CHAIRMAN OF THE SUPERVISORY BOARD
LEGAL AFFAIRS



SUSTAINABILITY

UDRŽITELNOST

Key features

ELISE 900 MK3



Side tilt 47°



Climbing angle 35°



Ground clearance 262mm

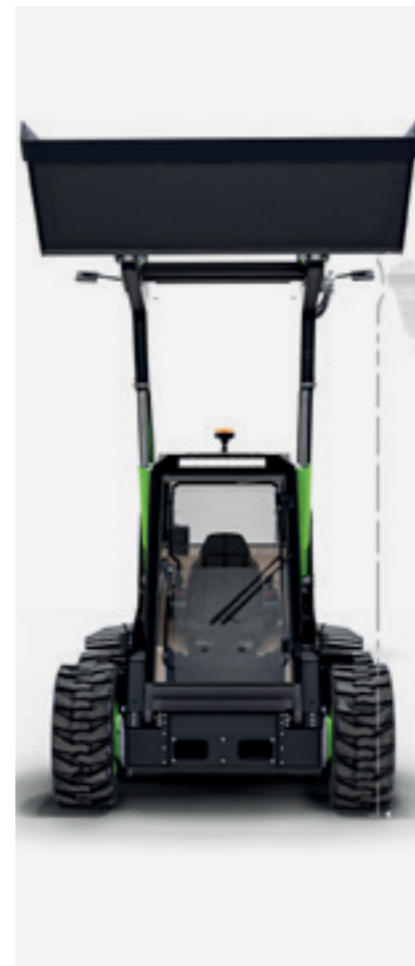

Hinge pin height 3637mm



Flexible prefabricated design



Zero emission, fully electric

The stable centre of gravity of the entire machine comes from the use of a uniform load, which is only made possible by battery powered technology.

Tipping load of 2400 kg



ROPS/FOPS certificated cabin up to 5000 kg



Speed of 12 km/h



Load of up to 1200 kg



Key features *miniZ400*

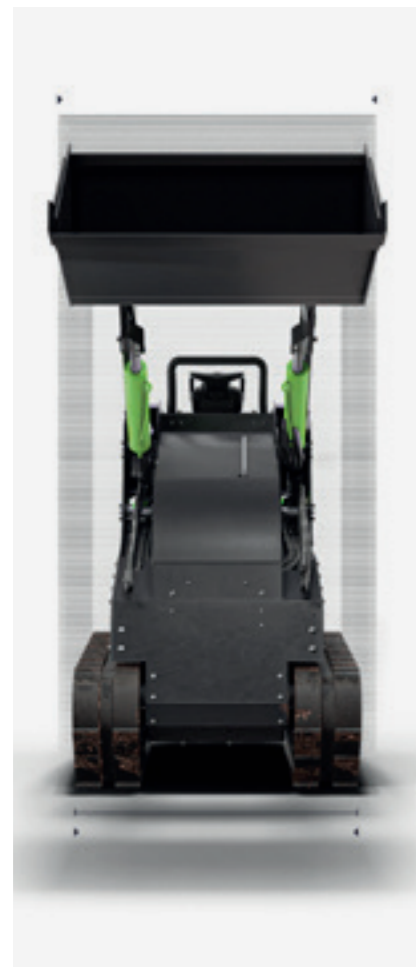

Compact loader with width of 790mm



Zero emission, fully electric



Remote control, removable controller, 50m of range



Tracked drive



Flexible prefabricated design



Two pairs of hydraulic cylinders

The stable centre of gravity of the entire machine comes from the use of a uniform load, which is only made possible by battery powered technology.

Tipping load of 800 kg



Speed of 5 km/h



Load of 400kg

We are not indifferent to the world in which our children and their children live and will live. We are not indifferent to the state of the environment.

That is why our machines do not pollute the environment with emissions or excessive noise. That is why we do not burden the environment with unnecessary waste. The batteries used in our machines are fully recyclable.

„Our projects must be more than just profitable. Our ambition is not to save the world, but to use smart technology to help solve local problems and develop local communities.“

VÁCLAV AUDES
CHAIRMAN OF THE SUPERVISORY BOARD
LEGAL AFFAIRS

ENVIRONMENT

VZTAH K PŘÍRODĚ

CLEAN ENERGY

We are aware that batteries are a key part of our machine's performance and reliability. That's why we are constantly striving to increase their capacity, shorten charging times and increase the number of charging cycles. Our newest lithium-ion battery, as well as older lead-acid got BST and MSDS documents and UN38.3 certification as well - their transportation is no problem whatsoever.

SILAD



LEAD-ACID BATTERY

5_h

charging time

HOPPECKE



SMART LEAD-ACID BATTERY

6+_h

of operation

FLASH[®]
BATTERY

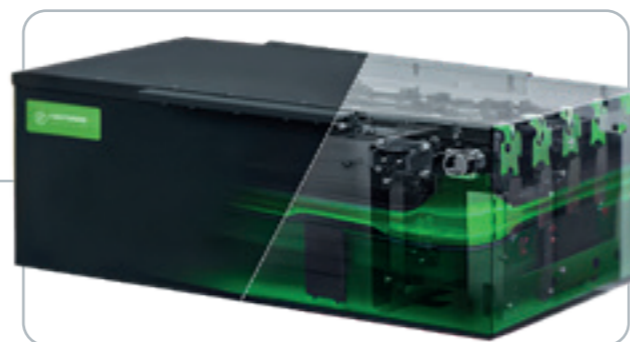

LITHIUM BATTERY

100%

recyclable

1700

charging cycles



380_v

3phase charging with
Star Charger/HOPPECKE

220_v

1phase charging
ZIVAN

110_v

1phase charging
ZIVAN

FLASH[®]
BATTERY

UHS
JAKOS

HOPPECKE

SILAD

We strive to keep our machines working flawlessly. To be trouble-free. To be easy to operate. In short, to make people's jobs as easy as possible.

„Since I was a child, the main thing that bothered me about my grandparents' farm was the breakdown of the machines, which added endless extra hours of work. Hours mean time, of which everyone has so little. That's why I always try to come up with a solution that saves time. That's why we make machines that are fail-safe.“

JÁN HANES

MEMBER OF THE SUPERVISORY BOARD
SENIOR DEVELOPER



RELIABILITY

SPOLEHLIVOST

SERVICE AND MAINTENANCE

We provide and continuously develop diagnostic tools for our clients with the ability to remotely access a specific machine to provide key operational information. Clients can also access all operational and service documentation through their user account.

NO OPERATING FLUIDS

HIGH SERVICE LIFE OF HYDRAULIC FLUIDS

REMOTE DIAGNOSTICS

REMOTE REPAIRS

COLLECTION AND ANALYSIS OF ERROR MESSAGES

EASY REPLACEMENT OF ALL COMPONENTS

MONITORING AND SOLVING OF ANY PROBLEMS



We enjoy inventing new solutions. That's why our machines are modular. And that's why they, along with all their functions, are remotely controllable, both in front of the remote control and via the mobile app. This makes our machines different...

„When I was a kid in kindergarten, I used to add little electric motors and lights to my cars, which was not met with understanding from my teachers. Fortunately, my dad continued to supply me with various servo motors. Thanks to him, I have been inventing new creative solutions to seemingly simple problems since I was very young.“

JÁN HANES

MEMBER OF THE SUPERVISORY BOARD
SENIOR DEVELOPER



CREATIVITY

KREATIVITA



BIG & SMALL
VELKÝ A MALÝ

MANUFACTURING

„Ever since my childhood we have had a small farm in our family and we take care of meadows and pastures and cattle. We often worked with our hands and manpower only, and I started thinking about machines that would make our work easier and save the environment at the same time.“

SLAVO PETRENEC
SENIOR DEVELOPER

„I enjoy it immensely when I bring back the sound of an old radio or get an old car up and running. I like vintage cars, from which you can learn the work of the old masters who found simple solutions in complex machines. I then use this experience to further develop our technology.“

JÁN HANES
SENIOR DEVELOPER



We're growing exponentially.

Number of machines produced and company turnover.



2018

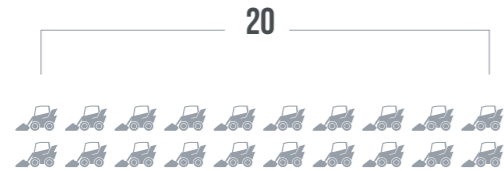

2019



2020

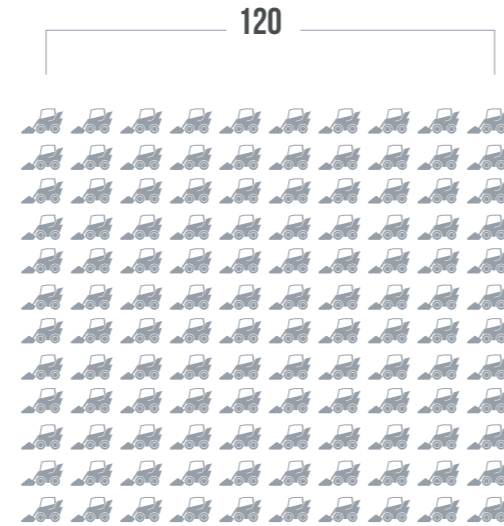

2021

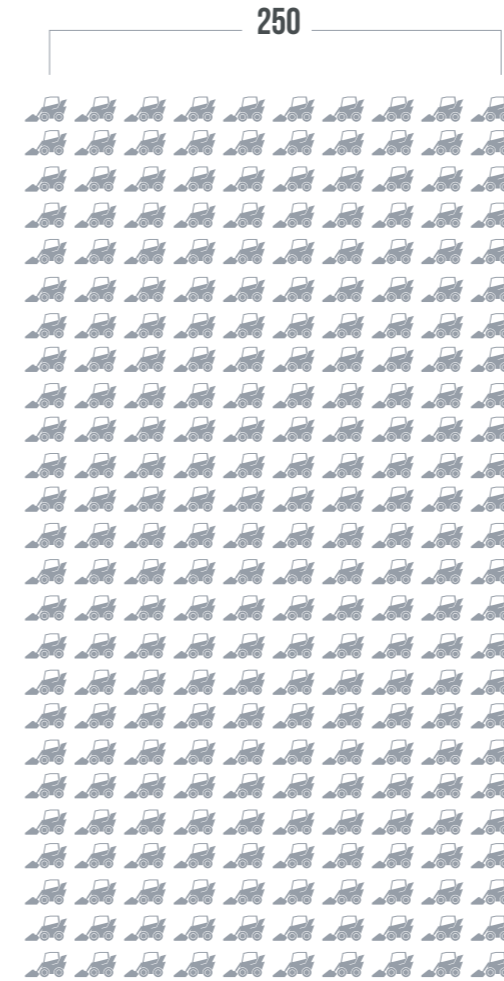

2022

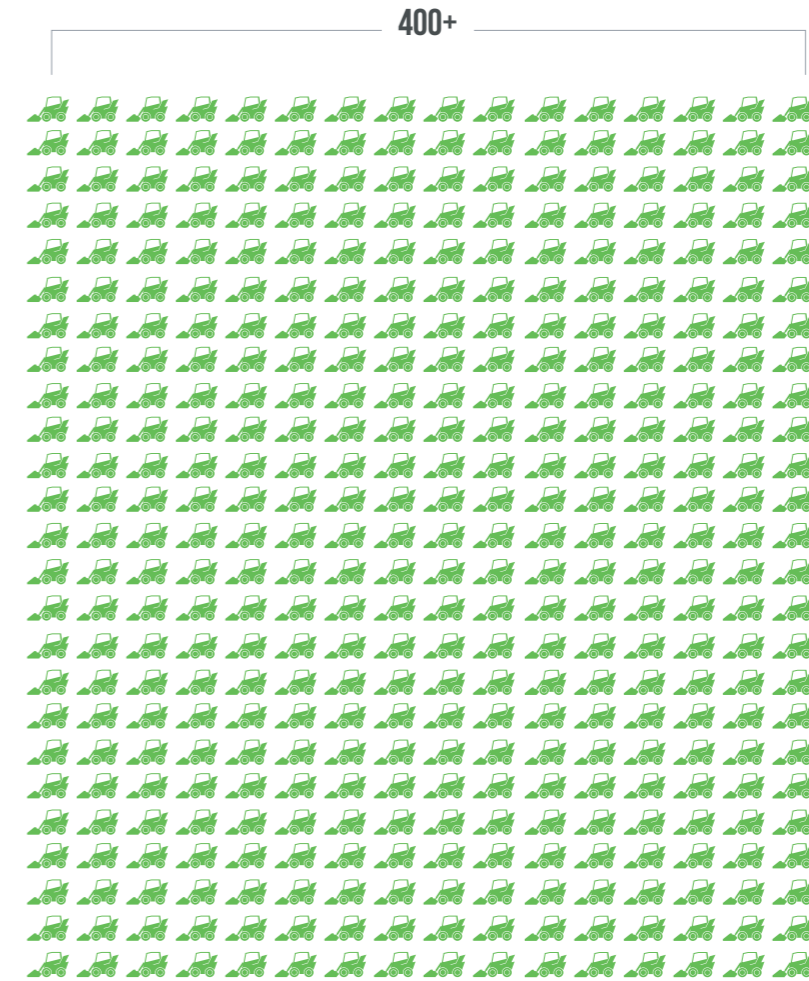

2023

COMPANY TURNOVER

2020	1,224,000 €
2021	4,979,000 €
2022	9,959,000 €
2023 by plan	19,456,851 €

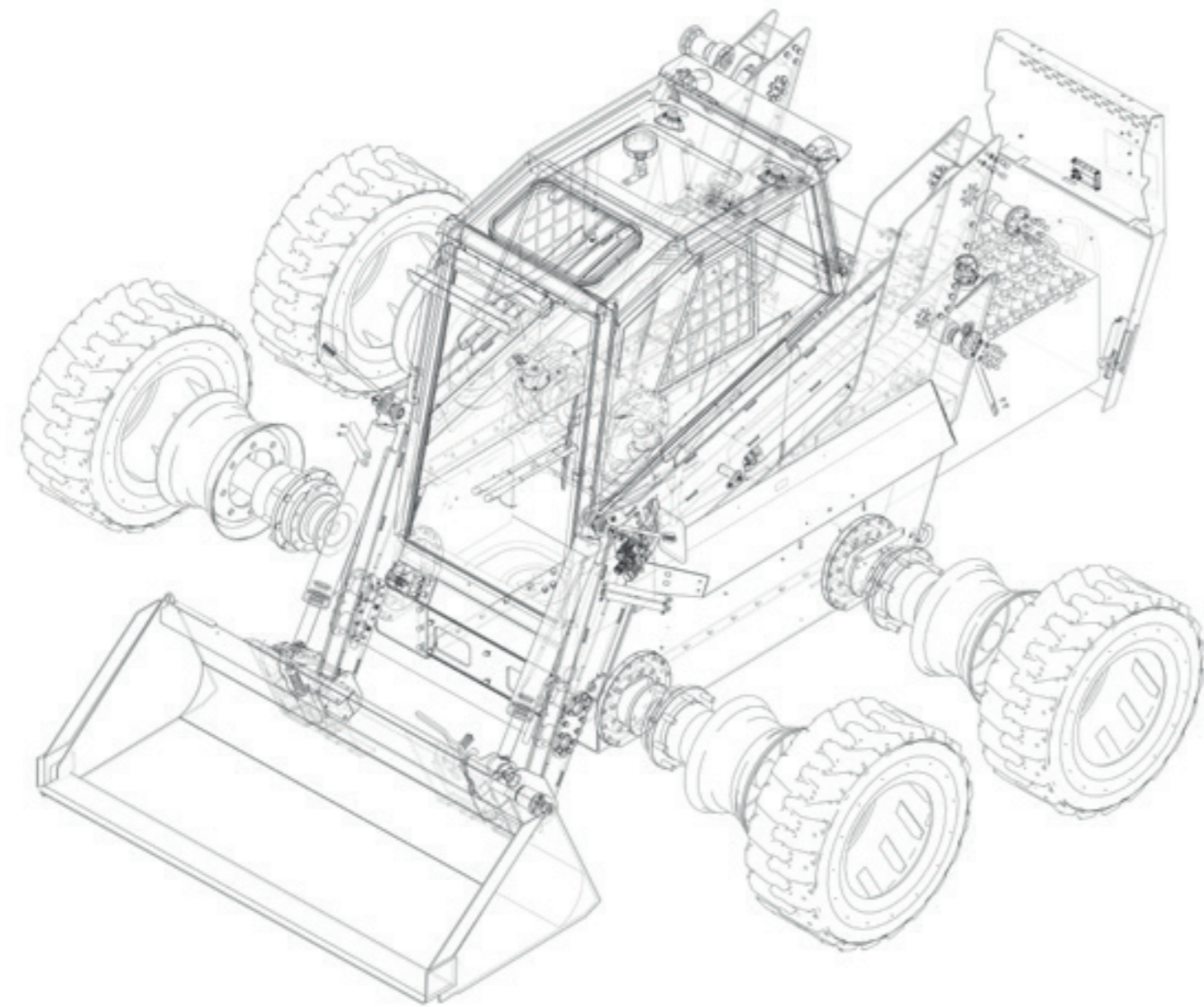

Modular construction.

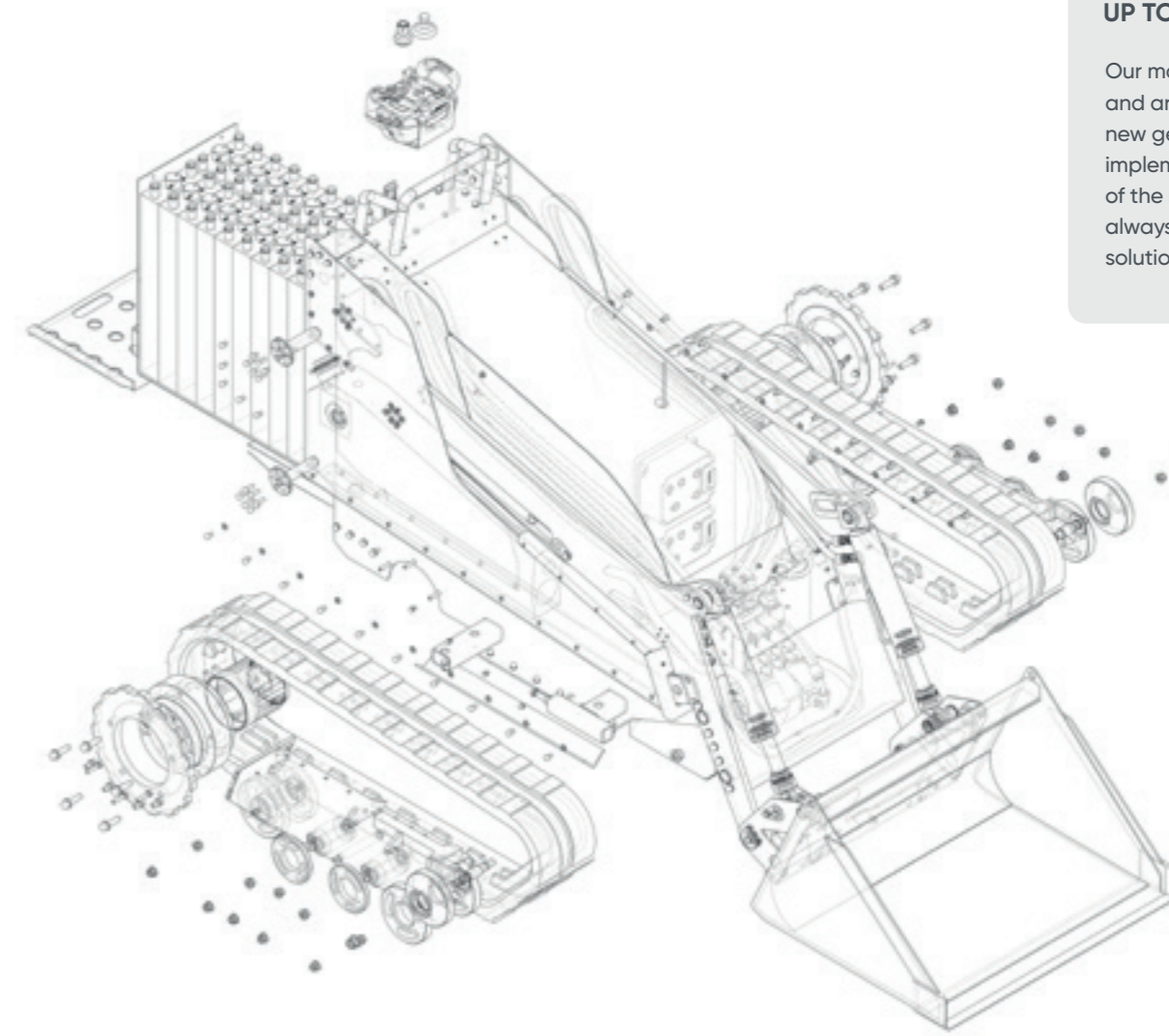

**KEEP YOUR MACHINE
UP TO DATE**

Our machines are 98% recyclable and are constructed so that every new generation features can be implemented to the older generation of the machines. Keep your machines always up to date through smart retrofit solutions and protect our environment.

ELISE 900 MK3

Third generation loader.

100% ELECTRIC

ZERO ENVIRONMENTAL IMPACT

GRAVITY BALANCING

HIGHER CLEARANCE

HIGHER LIFT THAN COMPETING MACHINES

WEIGHT AND STABILITY

MICRO DRIVE FOR SMOOTH AND CONTROLLED MOVEMENT



Powered with technology.

Elise 900. The world's first electric skid steer loader represents the highest technology and years of experience of FIRSTGREEN Industries.

Battery endurance

6+ hours

Dependant on use, conditions and configuration

Hinge pin height

3637 mm

356mm higher reach than the competing average

Side tilt

47°

10° higher tilt angle than competing average

Chassis Clearance

262 mm

44 mm higher than competing average

Remote control

50 m

15 m with smart app

Loading capacity

900 kg

1200 kg when using 400Ah capacity extended battery

100% electric, extremely low noise, 0 emission

On stock in 3 days

Lithium battery available

Low operational costs

Retrofitable modular construction

Microspeed for precise control

Self-leveling gyro platform



ELISE 900 MK3

Discover new generation.



Surface treatment

The third generation Elise 900 is different at first glance. Thanks to new surface treatment technology and powder coating, the machine is now more scratch and rust resistant. That gives it an attractive appearance, improves washability and makes for easier maintenance.



Joysticks

The control joysticks have been completely replaced. They are now more precise, with less resistance and the possibility of adjusting their parameterization, so it is a more intuitive control system that can be customized according to your own preference.



Hard-mount display

A major change to the machine's controls is the new option of hard mounted display, an accessory that acts as the machine's central control panel. It offers a real-time overview of the machine's tilt, along with sub-menus for error messages and advanced diagnostics.



Hydraulic motor

The third generation Elise also brings the new option of driving without the hydraulic pump, when the system switches to stand-by mode. This not only allows the Elise 900 to operate more quietly when moving between locations, but also, of course, to save energy.



Electronic brake

The brake system has also been changed. The third generation no longer features hydraulic brakes. We've fully replaced them by an electromagnetic braking system. This offers greater stability and confidence when stopping on a slope and simplifies maintenance.



Electronic drive motors

The Elise 900 now features European electric motors with 40Nm more torque. More power means smoother, more responsive turning. The power is also evenly distributed between forward movement and turning resulting in better precision and comfort for the operator.



Hydraulic cylinders

We have also improved the hydraulic cylinders. Their new generation is made of higher quality materials, using stronger metals, and a reinforced piston rod. These improvements increase their resistance to damage, longevity - reducing the need for servicing or replacement.

first.green/elise900improvebro



Find more improvements of the third generation Elise on our website.

miniZ400

Compact loader.

100% ELECTRIC

ZERO ENVIRONMENTAL IMPACT

GRAVITY LEVELLING

COMPATIBLE DESIGN

IDEAL FOR INDOOR CONSTRUCTION

EXTREME MANEUVERABILITY

BREAKTHROUGH DRIVE-TRAIN



Compact power, even on a glacier
MiniZ 400 on Mölltal Glacier

Compact loader.

MiniZ 400. Compact and precisely manufactured electric loader represents the highest technology and years of experience of FIRSTGREEN Industries.

100% electric, extremely low noise, 0 emission

On stock in 3 days

Lithium battery available

Compact modular construction

Remotely controled

Ideal for interior work

Powerful tracked drivetrain

Battery endurance

6+
hours

Dependant on use, conditions
and configuration

Maximum lifting height

2186
mm

Class leading for
extreme versatility

Load capacity

400
kg

Ultimate power in
a small package

Compact dimensions

1150^{height}
mm / **790**^{width}
mm

Fits through standard
doorways

Remote control

50
m

Maximum reach
for operator safety

Battery capacity

225
Ah

Fully charged in less
than 5 hours

REMOTE CONTROL

Our machines can be controlled conventionally by an operator inside the cab using a fixed control panel or a mobile phone app.

For added safety, the machine can also be fully controlled via joystick remote control, and the remote-control function in the mobile app can also be used for standby machine operation with direct visibility.

Control your machine from the warmth of your office. Teleoperation is a remote control of a machine using an internet data network (i.e. Wifi or 5G). The machine is equipped with cameras and sensors. That means the operator is able to control the machine remotely from anywhere in the world - safely and comfortably.



2,4 GHz Joystick controller

Elise 900 app for iOS and Android (2020)



Bluetooth connection

Radio connection



Mobile app

Mobile + Device + Joystick (2020)



Control panel

EXTENSIVE APPLICATION POSSIBILITIES

Elise 900 and MiniZ 400 make for a helper even in previously unthinkable places, environments, conditions and terrains. This also makes them unique machines.



Recreational, sports facility & mountain resort maintenance



Agriculture / Eco / Bio



Interior construction / Demolition



City construction / Demolition / Landscaping



Ports / Harbours / Ships



Power plant maintenance / Mining Industry



Check out our complete range of eAttachments for the full spectrum of our machine options.



SWEEPER



ANGLE SWEEPER



FORESTRY MULCHER



BRUSH CUTTER



SNOW BLOWER



CONCRETE MIXER



FARM FORKS



SIDE BRUSH SWEEPER

UNIVERSAL HELPER

FOR EVERY BUSINESS

F U T U R E I S

E L E C T R I C



@fgi.official



@firstgreen_industries



@firstgreen-industries



@firstgreenindustries

FIRSTGREEN Industries +420 737 63 37 33, info@first.green, U Plynárny 1002/97, 101 00 Prague, Czech Republic, ID CZ08900213

Visit our website at **first.green**.